

XTR Cassette Sprocket (10-speed)

CS-M980 bj/bk-Group

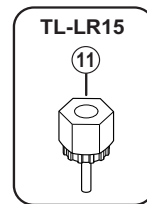
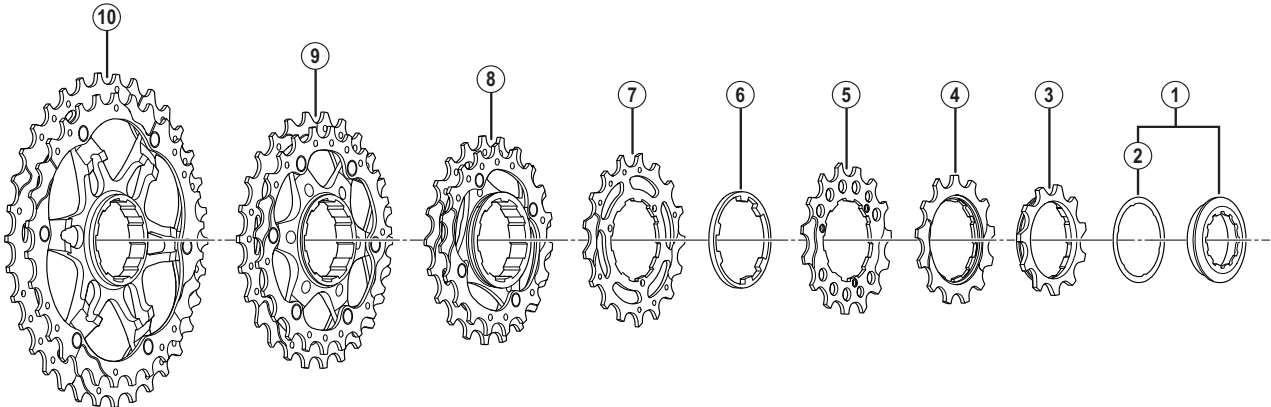

- bj-group sprocket teeth combination: 11-13-15-17-19-21-23-26-30-34T
- bk-group sprocket teeth combination: 11-13-15-17-19-21-24-28-32-36T

CS-M771-10

CS-HG81-10

ITEM NO.	SHIMANO CODE NO.	DESCRIPTION	INTERCHANGEABILITY	
			A	A
1	Y1YT98010	Lock Ring & Spacer		
2	Y10Z04000	Lock Ring Spacer	A	A
3	Y1YT11000	Sprocket Wheel 11T (Built in spacer type)		
4	Y1YT13000	Sprocket Wheel 13T (Built in spacer type) for bj-Group		
	Y1YT13010	Sprocket Wheel 13T (Built in spacer type) for bk-Group		
5	Y1YT15000	Sprocket Wheel 15T		
6	Y1Z805000	Sprocket Spacer (t=2.35 mm)	A	
7	Y1YT17000	Sprocket Wheel 17T		
8	Y1YT98020	Sprocket Unit (19-21T)		
9	Y1YT98030	Sprocket Unit (23-26T) for bj-Group		
	Y1YT98040	Sprocket Unit (24-28T) for bk-Group		
10	Y1YT98050	Sprocket Unit (30-34T) for bj-Group		
	Y1YT98060	Sprocket Unit (32-36T) for bk-Group		
11	Y12009230	Lock Ring Removal Tool (TL-LR15)	A	A

A: Same parts.

B: Parts are usable, but differ in materials, appearance, finish, size, etc.

Absence of mark indicates non-interchangeability.

Specifications are subject to change without notice.

Mar.-2017-3019A

© Shimano Inc. I

SHIMANO